

Congleton Half Marathon

Marshall Point Number: 5

Distance from Finish: 1.5 miles

Location: Hallgreen Lane/ Swettenham Road junction

Number of marshals assigned: 2

Hall Green lane will remain closed for the duration of the race. Amberon will erect a barrier south of the Swettenham Road junction.

General Instructions:

1. The safety of runners, marshals and other road users is the first priority of all marshals.
2. Make sure you always face oncoming traffic in your marshal position.
3. Please park cars safely and ensure you don't obstruct the road for runners or drivers..
4. Provide directions to runners as specified below. Please use hand signals and spoken instructions; tired runners don't always listen!
5. If a runner retires, please contact Marshal Control and we'll try to collect them as soon as possible.
6. Please offer words of encouragement, a smile, information on distance remaining etc.

Position Specific Instructions – OUTWARD DIRECTION

Swettenham Road will be closed and no traffic allowed onto Hall Green Lane (except emergency vehicles) from 9.15 until 10.15. The marshals are responsible for erecting the barrier on Swettenham Road provided by Amberon. This is to prevent any traffic on Radnor Bank at the start of the race.

There are some new houses at Woodside Park now. We need to give them access to their properties, so please let them through the barrier if they want to leave or get to their houses.

1. At 9.15 approx Erect the barrier provided by Amberon across Swettenham Road to close it before the race starts to stop traffic.
2. Ask drivers trying to leave Swettenham Road to wait until all runners have passed.
3. Traffic will not be allowed into Hall Green Lane from Giantswood Lane by Amberon
4. Remind runners to keep on left.
5. When the sweepers have passed, remove barrier and let traffic move along Swettenham Road again.

Position Specific Instructions – INWARD DIRECTION

After the barrier has been removed on Swettenham road traffic may turn left from Swettenham road onto Hall Green Lane, but WILL NOT be able to turn right. Any traffic from Giantswood lane will have to turn right into Swettenham road.

1. Marshals to warn drivers on Swettenham road of runners
2. Direct runners to continue on Hallgreen Lane towards Radnor Bank
3. Direct to run on left

Equipment:

Bib – please wear these for your safety

Mobile Phone with number of marshal coordinator at marshal control.

At End:

Wait until Sweeper passes and confirms all runners now passed by.

Return bib to Marshal Control at Congleton High School and drop it into the bin

Location of position 5:

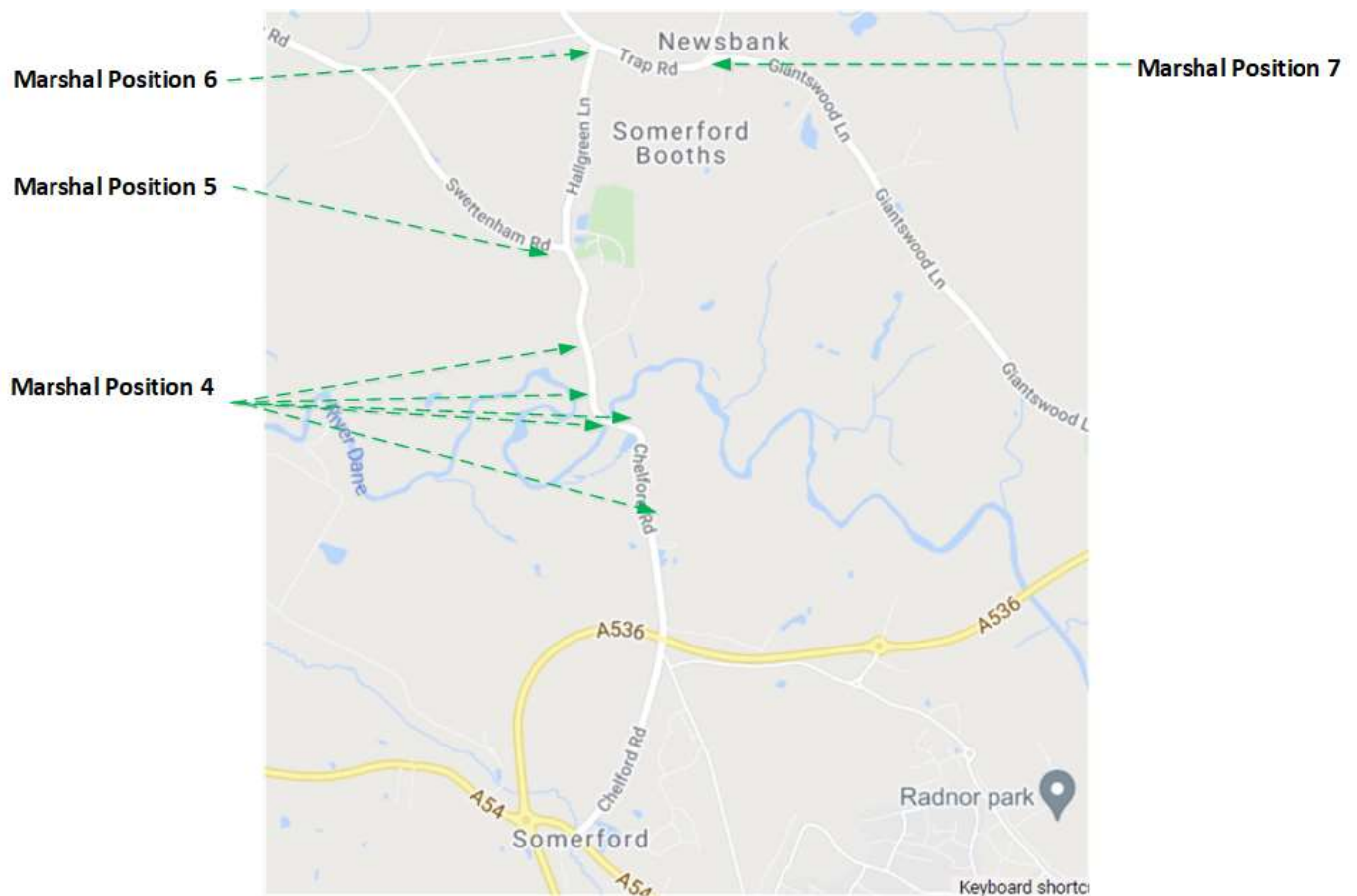

Plan of Marshal Position 5 Out – Swettenham Road junction with Hall Green Lane

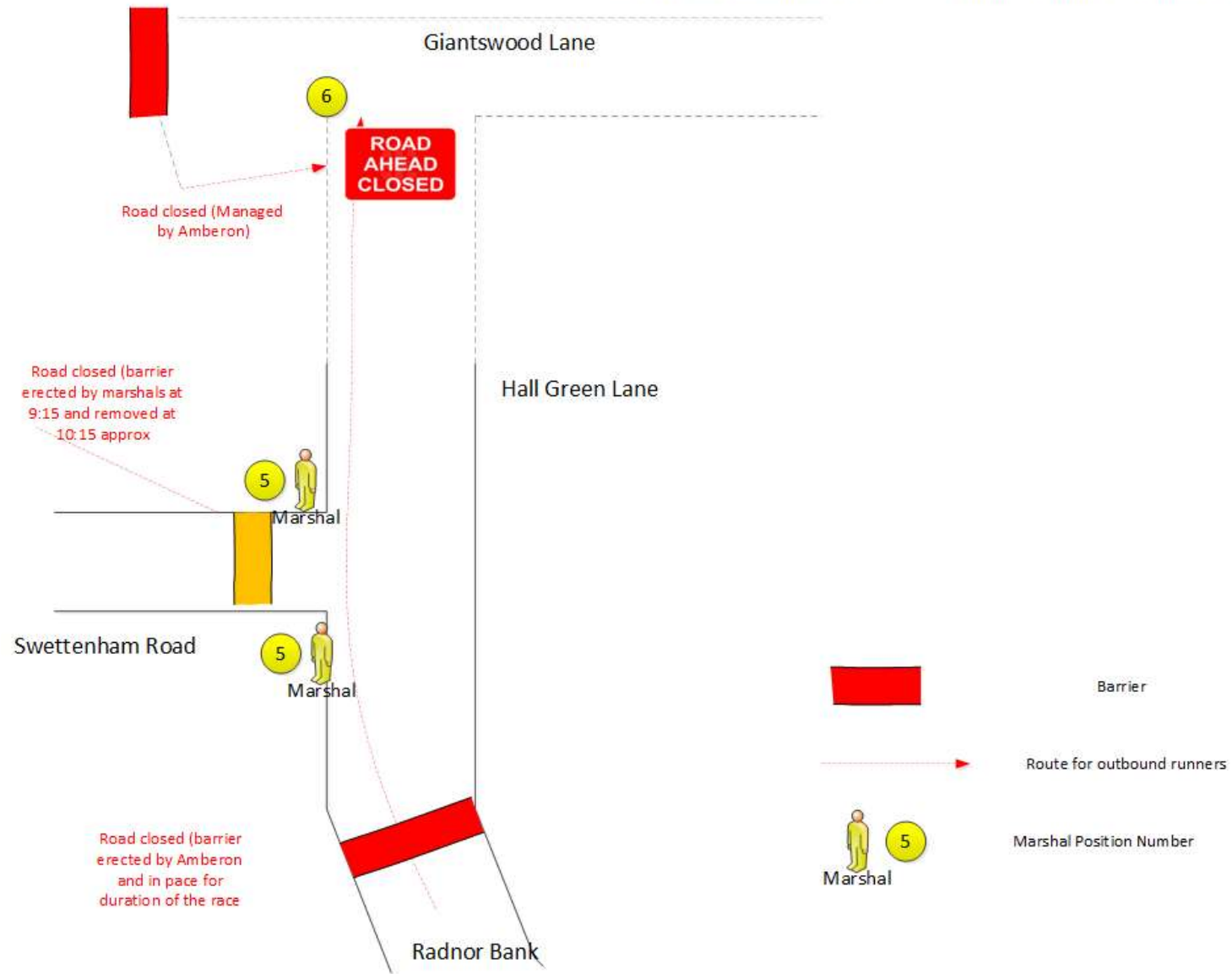

Inbound runners:

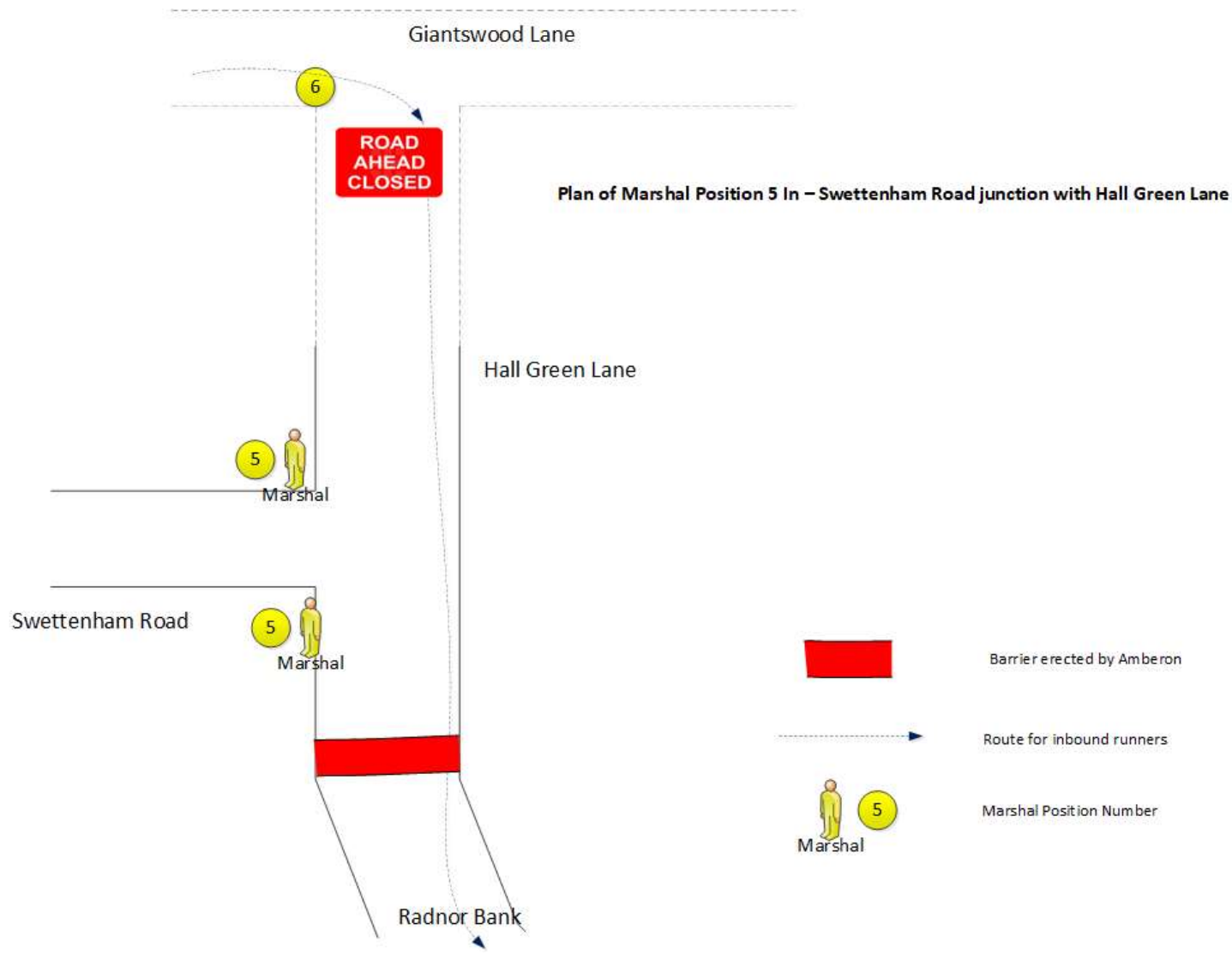

The road closures:

