

Congleton Half Marathon

Marshall Point Number: 4

Distance from Finish: 1.1 miles (from Radnor Bridge)

Location: Radnor Bank / Chelford Road

Number of marshals assigned: Outward 4. Inward 4.

Car parking is very limited on this road. Please walk or cycle if you can!

General Instructions:

1. The safety of runners, marshals and other road users is the first priority of all marshals.
2. Please stand in safe places on this stretch of road.
3. Make sure you always face oncoming traffic in your marshal position.
4. Please park cars safely and ensure you don't obstruct the road for runners or drivers..
5. Provide directions to runners as specified below. Please use hand signals and spoken instructions; tired runners don't always listen!
6. If a runner retires, please contact Marshal Control and we'll try to collect them as soon as possible.
7. Please offer words of encouragement, a smile, information on distance remaining etc.

Road closure details:

This year Radnor bank (Chelford Road/Hall Green Lane) will be closed to all except residents traffic for the whole race – 0900-1230. This should make the Radnor Bank stretch of the course much safer for outbound and returning runners.

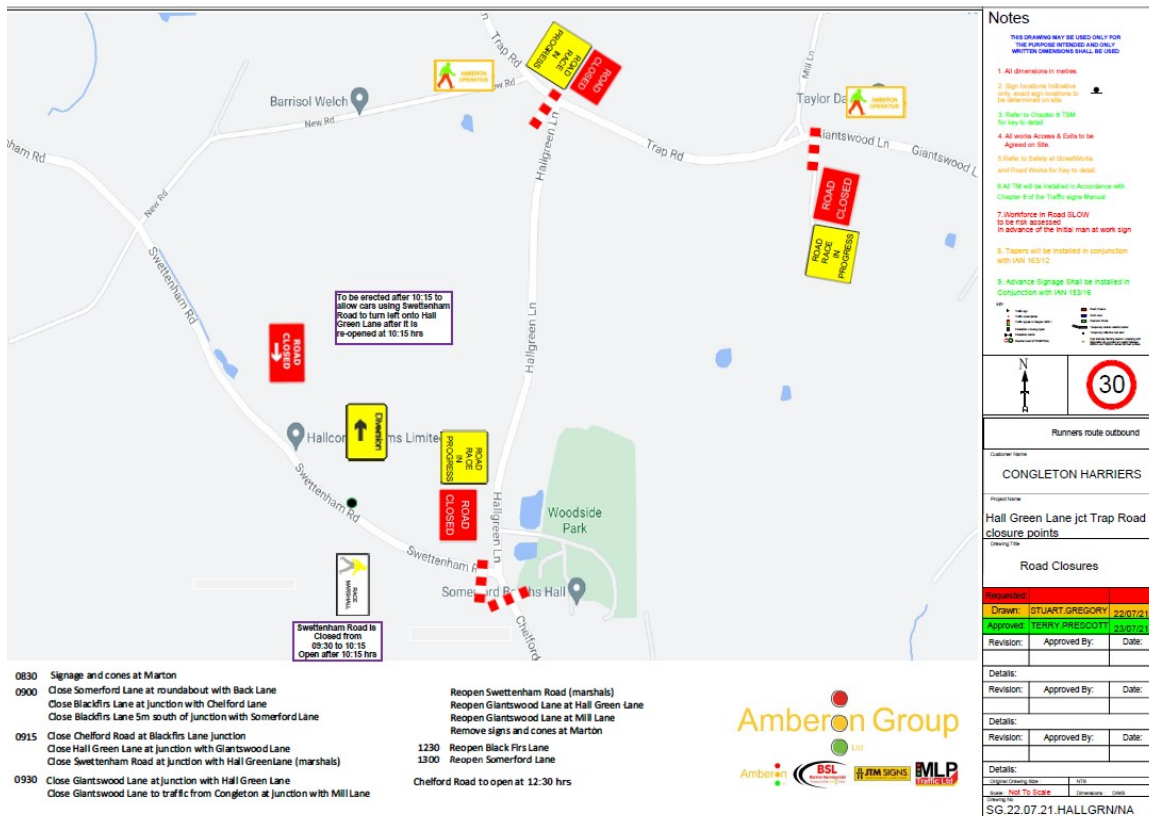

Hall Green Lane closures



Start area closures

Position Specific Instructions – OUTWARD DIRECTION (see picture):

For OUTWARD direction, there should be reduced traffic because Chelford Road will be closed until all runners have reached Giantswood Lane.

1. Position marshal on Chelford Road where road starts to descend and narrow.

2. Position a marshal on OUTSIDE of bends to either side of Radnor Bridge (ensure you are visible).
3. Position marshal on ascent of Radnor Bank where road starts to narrow.
4. Position a marshal above the temporary traffic lights on Radnor Bank.
5. Warn runners clearly to run on LEFT
6. Warn traffic of runners in the road

Position Specific Instructions – INWARD DIRECTION (see picture):

For INWARD direction, there will be reduced traffic. Please be aware, because a small number of vehicles may be using the road – local residents on Hall Green lane for example.

1. Position marshals in safe positions but have one additional marshal at each bend near Radnor Bridge.
2. Marshals to warn drivers of runners and slow traffic down
3. Marshals to stress to runners that they must stay on the left at all times
4. Direct runners to continue on Chelford Road, up Radnor Bank
5. Direct to run on left

Equipment:

Bib – please wear these for your safety

Mobile Phone with number of marshal coordinators at marshal control

At End:

Wait until Sweeper passes and confirms all runners now passed by.

Return bib to Marshal Control at Congleton High School, drop the bib into the bin.

