

Congleton Half Marathon

Marshall Point Number: 2

Distance from Finish: 0.4 miles

Location: Black Firs Lane / Chelford Road junction

Number of marshals assigned: 3

Chelford road through to Hall Green lane will now be closed for the duration of the race. This will mean that there will be much reduced traffic approaching this position, but please be careful, there could still be some vehicles. Residents on Hall Green Lane will still be able to access their properties and may need to pass through the barriers on Black Firs Lane.

General Instructions:

1. The safety of runners, marshals and other road users is the first priority of all marshals.
2. Make sure you always face oncoming traffic in your marshal position.
3. Please park cars safely and ensure you don't obstruct the road for runners or drivers.
4. Provide directions to runners as specified below. Please use hand signals and spoken instructions; tired runners don't always listen!
5. If a runner retires, please contact Marshal Control and we'll try to collect them as soon as possible.
6. Please offer words of encouragement, a smile, information on distance remaining etc.

Position Overview:

Chelford road from Black Firs lane to Holmes Chapel road is closed for roadworks. Blackfirs Lane and Hall green Lane will be closed just before Somerford Lane throughout the race by the traffic management company. Somerford Lane will be closed throughout the race by the TM company.

Please be aware that cyclists, pedestrians and horses may still use Somerford Lane. The pavement has a cycle lane!

We have no marshal position at the end of the old Back Lane. This road is closed off and there are only a handful of properties on it. However at the start of the race it would be advisable for one marshal to stand at the end of the old Back Lane in case traffic does come out.

Road Closure Details:

See details of road closures in the diagram below:

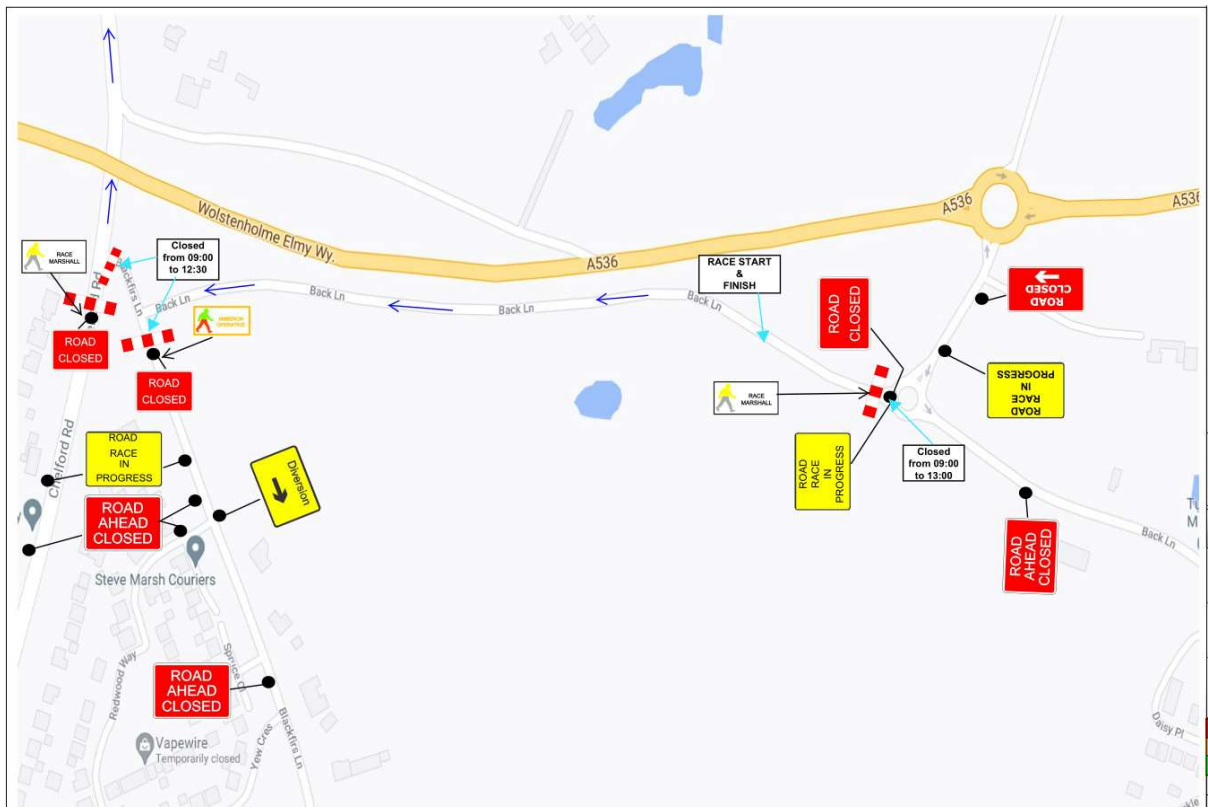

Fig 1 Schematic of Road Closures at start

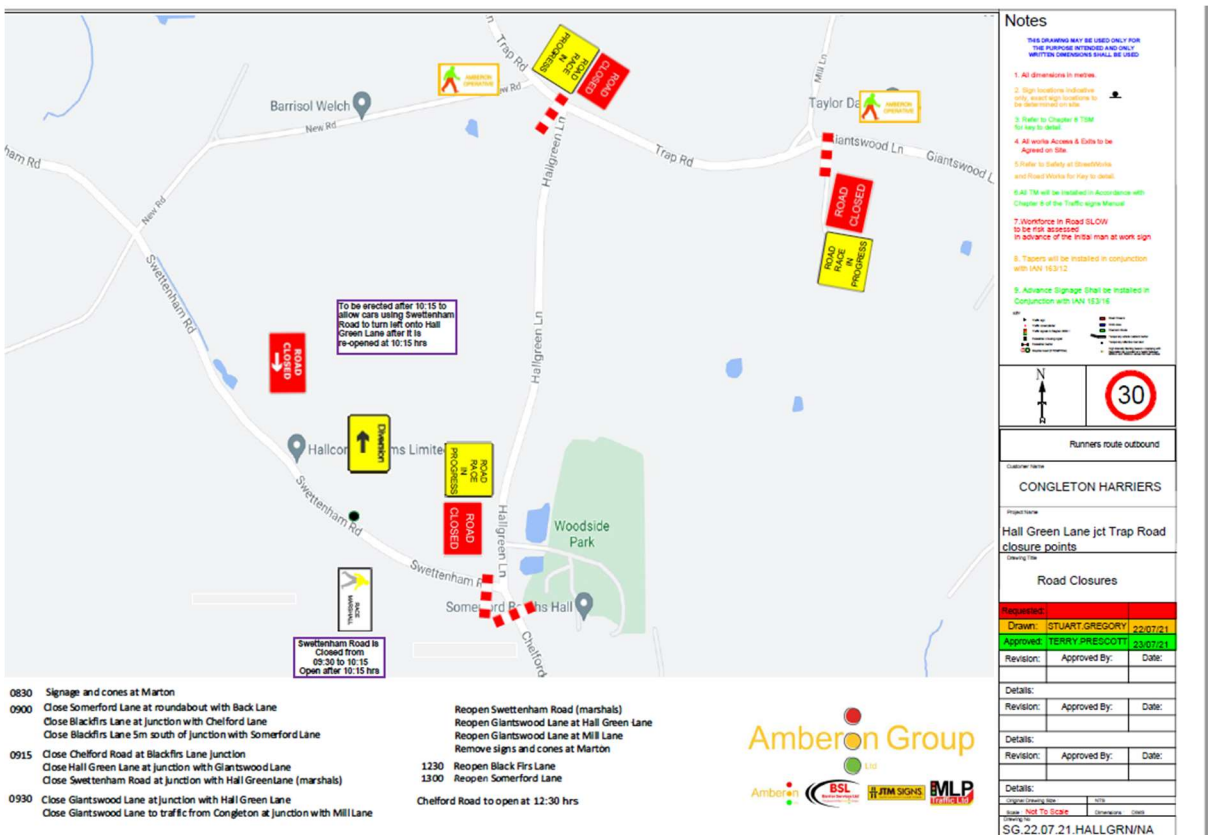

Fig 2 Schematic of Road Closures on Hall Green Lane

The approximate timetable for closing and opening roads is:

Time	Action
0830	Signage and cones in place at Marton

0830	Close Somerford Lane at roundabout with Back Lane
0900	Close Blackfirs Lane at junction with Chelford Road Close Blackfirs Lane 5 metres south of junction with Somerford Lane
0900	Close Hall Green Lane at junction with Giantswood Lane Close Swettenham Road at junction with Hall Green Lane (marshals)
0915	Close Giantswood Lane/Trap Road at junction with Hall Green Lane Close Hall Green lane south of Swettenham road Close Giantswood Lane to traffic from Congleton at junction with Mill Lane
1015	Reopen Giantswood Lane at Hall Green Lane Reopen Giantswood Lane at Mill Lane Remove signs and cones at Marton
1230	Reopen Black Firs Lane and Hall Green lane
1300	Reopen Somerford Lane

Table 1 Timetable for Road Closures

Position Specific Instructions – OUTWARD DIRECTION (see picture):

1. One marshal to go to the old Back Lane in case traffic appears during the start.
2. Direct runners to run to turn RIGHT onto Chelford Road and then keep left.
3. Warn drivers of runners and apologise for delay
4. Direct to run on left
5. Amberon operators will reopen Chelford Road/Hall Green Lane at 1230.

Position Specific Instructions – INWARD DIRECTION:

1. Chelford Road will be open, so be aware of traffic in both directions. Stand facing traffic and not with your back to traffic. Do not stand in the road on Chelford Road.
2. Traffic will not be allowed to turn into Black Firs Lane, but will need to follow the diversion via Homles Chapel road.
3. Direct runners to run to turn LEFT on to Black Firs Lane and left onto Somerford Lane.
4. Direct to run on left
5. Warn any drivers of runners

Equipment:

Bib – please wear these for your safety

Mobile Phone with number of marshal coordinators at marshal control

At End:

Wait until Sweeper passes and confirms all runners now passed by.

Return bib to Marshal Control at Congleton High School, drop the bib into the bin.

Plan of Marshal Position 2 Out - Black Firs Lane and Somerford Lane junctions with Chelford Road

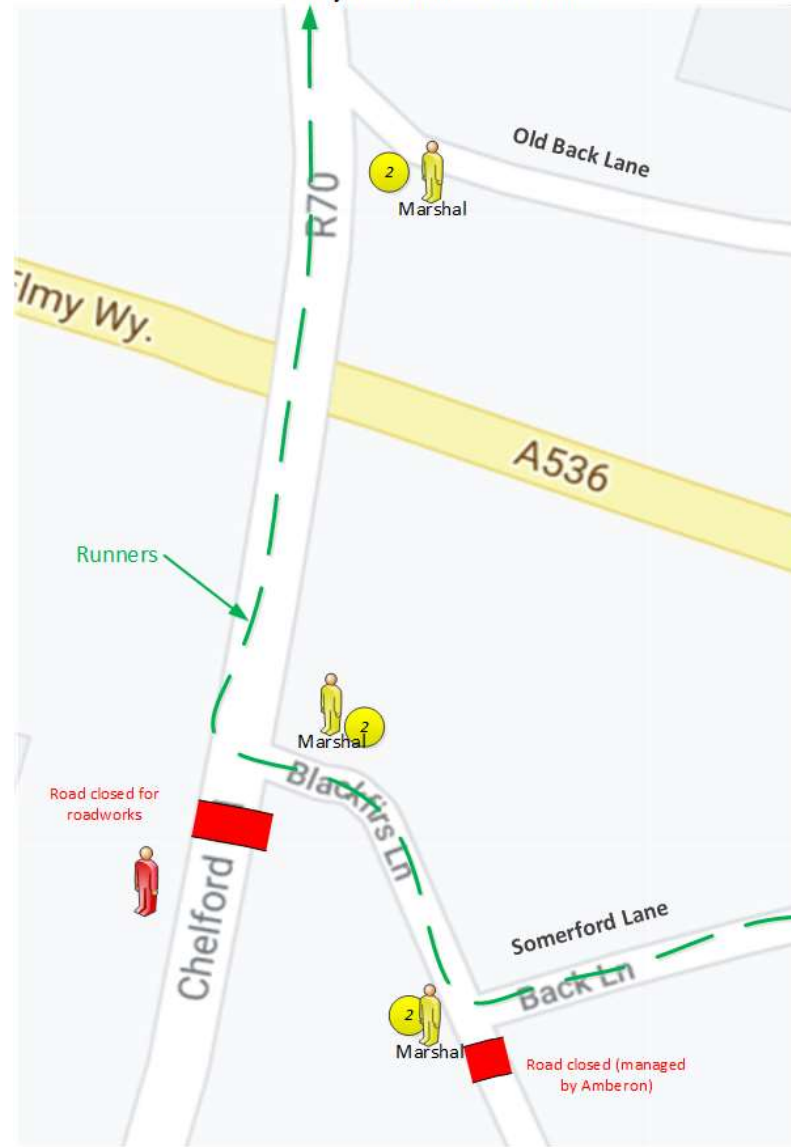

Plan of Marshal Position 2 In - Black Firs Lane and Somerford Lane junctions with Chelford Road

