

Client:
Congleton Harriers

Project Type:
Road Closures

Congleton 1/2 Marathon
- Closure Points

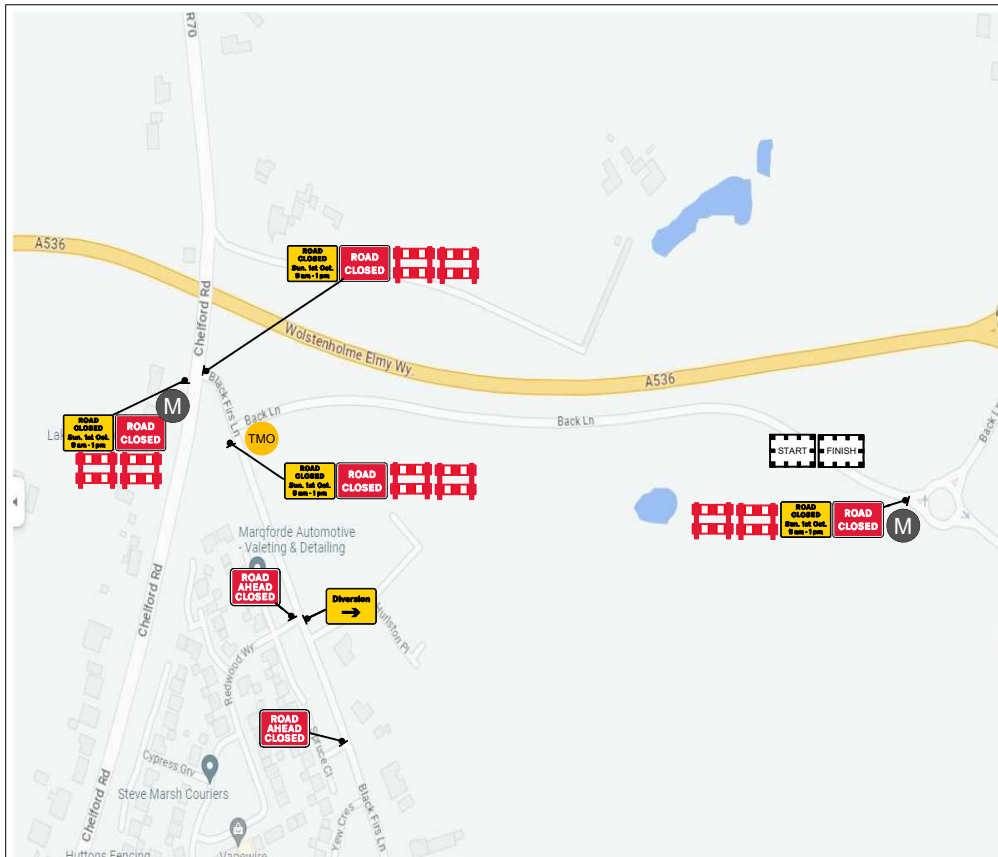

Qty: 5 Ref: 13.9 Schedule 13-9 : Temporary Information	
Qty: 3 Ref: 13.9 Schedule 13-9 : Temporary Information	
Qty: 3 Ref: 13.9 Schedule 13-9 : Temporary Information	
Qty: 1 Ref: 13.9 Schedule 13.9 : Temporary Information	
Qty: 2 Ref: 13.9 Schedule 13-9 : Temporary Information	
Qty: 3 Ref: 13.9 Schedule 13-9 : Temporary Information	
Qty: 1 Ref: 2702 Start of temporary diversion route	
Qty: 2 Ref: 2702 Start of temporary diversion route	
Qty: 1 Ref: 2702 End of temporary diversion route	
Qty: 2 Ref: 2703 Direction of temporary diversion route from junction ahead	
Qty: 3 Ref: 2703 Direction of temporary diversion route from junction ahead	
Qty: 8 Ref: 7010-FP-13-9 Nature of temporary hazard ahead - Road Closed	
Qty: 2 Ref: 7010.1 Nature of temporary hazard ahead - Road Ahead Closed	

- Back Lane – from roundabout to Black Firs Lane closed from 9am to 1pm
- Black Firs Lane - from junction with Back Lane to Chelford Road closed 9am to 1pm
- Chelford Road – from junction with Black Firs Lane to junction with Swettenham Road closed 9am to 1pm
- Hallgreen Lane – from junction with Swettenham Road to Trap Road closed from 9.30am to 10.15am
- Trap Road – from junction with Hall Green Lane to Giantswood Lane closed from 9.30am to 10.15am
- After these points, all runners will be on open road and under the control of the event organisers until arriving back at Hall Green Lane

TMO 12d Qualified Traffic Management Operative

Chapter 8 Barrier (plastic)

M Event Marshall (appointed and managed by event org.)



JT & M Signs Ltd
Unit 20a HTM Business Park
Rhuddlan
Denbighshire LL18 5UZ
01745 590056
info@jtmroadsigns.co.uk

Advanced Warning Signs date:	22/09/23	Drawn By:	SW	Checked By:	
Erect / Start date:	01/10/23	Scale:	Original Drawing A3 NOT TO SCALE	Date:	25/06/23
Start Time:	09:00	Drawing:	1 of 1	Issue:	
Finish Date:	01/10/23	Drawing / Project No:			
Finish Time:	13:00	JTJ01OCT02/2		ON SITE SPECIFIC ITRA-002 For JTM Operatives MUST BE COMPLETED PRIOR TO COMMENCEMENT OF ALL WORKS. NOT TO BE REPRODUCED WITHOUT THE PERMISSION OF JT & M SIGNS LTD.	